

BEST OF ASCO[®] 2025

OFFICIALLY LICENSED

AUGUST 1-2, 2025 | JW Marriott Marquis Miami



2025 OFFICIAL ANNUAL MEETING REVIEW

EDUCATIONAL PARTNERS



TABLE OF CONTENTS

<i>Topic</i>	<i>Page</i>
<i>General Information</i>	<i>3</i>
<i>Program Overview</i>	<i>4</i>
<i>Educational Credits</i>	<i>5</i>
<i>CME Mobile App</i>	<i>6</i>
<i>Activity Codes</i>	<i>7</i>
<i>Faculty</i>	<i>8-14</i>
<i>Disclosures</i>	<i>14-17</i>
<i>Educational Partners</i>	<i>18</i>
<i>Program Schedule</i>	<i>19-22</i>
<i>Important Reminder</i>	<i>23</i>
<i>Blank Space for Notes</i>	<i>24</i>

GENERAL INFORMATION

PARKING INFORMATION

JW Marriott Marquis Miami offers discounted rates to the symposium's attendees as follows:

Valet: Bring parking ticket to the valet

- Overnight Valet - \$56.60 inclusive of taxes per car per night.
- Daily Visitor Valet Parking
 - 2-4 hours \$39.38 per vehicle per day (inclusive of taxes)
 - 4-8 hours \$47.99 per vehicle per day (inclusive of taxes)
 - 8+ hours \$57.83 per vehicle per day (inclusive of taxes)

Self-Parking: Met 3 parking garage is located next to Whole Foods Market on SE 3rd Avenue.

****Please read the information and instructions below carefully***

- \$15.00 (+ tax) with **validation up to 12 hours.**
- Attendees must scan the QR code that is in the parking garage and add the code ***SELFJWMM*** for the discounted rate to apply.

BADGES

Issued badges must be worn at all times during the course of the symposium. You may return the badge at the end of the symposium for recycling.

ATTIRE

Attire for the symposium is business casual. Please bring a sweater or jacket as meeting room temperatures and personal comfort levels vary.

PRESENTATION SLIDES

The slides shown during the symposium will be available after the symposium on our MHS CloudCME websites. Attendees will receive an email with instructions to access the slides.

CONTACT INFORMATION

Should you have any questions or require assistance during or after the symposium, please contact the Office of Continuing Medical Education by emailing cmdept@mhs.net.

PROGRAM OVERVIEW



ACCREDITATION

Memorial Healthcare System is accredited by the Accreditation Council for Continuing Medical Education to provide continuing medical education for physicians.

PURPOSE STATEMENT

Memorial Cancer Institute's **Best of ASCO®** is a program licensed by the American Society of Clinical Oncology (ASCO) and designed to present the most recent abstracts and guidelines presented at the 2025 American Society of Clinical Oncology Annual Meeting.

The goal of this educational session is to incorporate recent advances in the treatment of cancer into clinical practice. National and International faculty will review state of the art developments in hematology, oncology, surgical oncology, and radiation oncology. Participants will have the opportunity for audience interaction with the faculty.

Memorial Cancer Institute (MCI) is a leading Cancer Institute in Florida and is part of the Memorial Healthcare System, the third largest public health care system in America. This important event is partnering with the Moffitt Cancer Center Hematology Malignancies and BMT Unit at Memorial Healthcare System; the Florida Society of Clinical Oncology (FLASCO); and the Charles E. Schmidt College of Medicine at Florida Atlantic University (FAU).

TARGET AUDIENCE

Medical, Surgical, and Radiation Oncologists, Radiologists, Internal Medicine Physicians, Nurse Practitioners, Oncology Nurses, Physician Assistants, Pharmacists, Physical Therapists, Speech and Occupational Therapists, and other healthcare professionals.

EDUCATIONAL OBJECTIVES

At the completion of this symposium the participants should be able to:

- Expose hematologist/oncologists to data from relevant ongoing clinical research presented at ASCO that year. Emphasizing the latest developments in oncology.
- Close the knowledge gaps of other Allied Health Specialists (PharmDs, ARNPs and nurses) who need to know how to administer novel, approved therapies. These APPs need to know the clinical applications, changes in the labeling of therapies and new toxicities reported in targeted agents.
- Teach clinicians to incorporate new data, like biomarker information, and new standards of care into their clinical practice.
- Close the gap in knowledge between healthcare professionals and patients related to overall survival, progression-free survival, recurrence rates, and toxicity for novel therapies which have either been recently approved or are on their way to clinical approval.
- Improve clinicians' information on specific drug therapies (topics in solid tumors specially related to targeted therapy current and in development, Immunotherapy, drug administration and treatment plans), their toxicities, side effects and corresponding supportive care of the oncology patient.
- Develop guidelines for best practices of Standard of Care treatment. These guidelines may be disease orientated which will address specific clinical situations, or they may be modality-oriented and address medical devices, procedures and tests.



Download the mobile app (instructions on page 6) to claim credits, complete required evaluation and download the certificate.

PHYSICIANS

Memorial Healthcare System designates this live activity for 6.5 CMEs Friday and 5.5 CMEs Saturday (**maximum 12 AMA PRA Category 1 Credits™**). Physicians should claim only the credit commensurate with the extent of their participation in the activity. Please contact Memorial Healthcare System's CME Department at cmdept@mhs.net for questions.

NURSES

Memorial Healthcare System is an approved provider of Nursing Continuing Education. Contact hours will be awarded based on attendance each day; 6.5 CEUs Friday CE Broker# 20-1309988 and 5.5 CEUs Saturday CE Broker# 20-1309991 (**maximum 12 hours**). Please contact Memorial Healthcare System's Nursing Education Department, Anna Dore, at adore@mhs.net for questions.

PHARMACISTS AND TECHNICIANS GENERAL

The Best of ASCO® program has been approved for Pharmacist and Pharmacy Technician General CE by the Florida Board of Pharmacy coordinated through the Memorial Cancer Institute Pharmacy Department. Contact hours will be awarded based on attendance each day. 6.5 CEUs Friday and 5.5 CEUs Saturday (**maximum of 12 hours**). Please contact Memorial Cancer Institute's Pharmacy Department, Frank Gentile fgentile@mhs.net for questions.

PHYSICIAN ASSISTANTS

AAPA accepts AMA Category 1 Credits™ from organizations accredited by the ACCME. Please use certificate obtained through the Mobile App to self-report.

NURSE PRACTITIONERS

AANP accepts AMA Category 1 Credits™ from organizations accredited by the ACCME. Please use certificate obtained through the Mobile App to self-report.

PHYSICAL THERAPISTS

FPTA accepts AMA Category 1 Credits™ from organizations accredited by the ACCME. Please use certificate obtained through the Mobile App to self-report.



Attendance Via Mobile App

1. Memorial Healthcare Systems' CME application, CloudCME® Mobile App, is available for [Apple](#) or [Android](#). Search for "CloudCME" in your app store and start downloading the app.
2. Once download is complete, follow the screen instructions to start configuration. Type "MHS" when asked for the organization code.
3. **CloudCME account is required.** Memorial Healthcare System staff already have an account in the system. Non- Memorial Healthcare System staff must create a new account once you download the app.

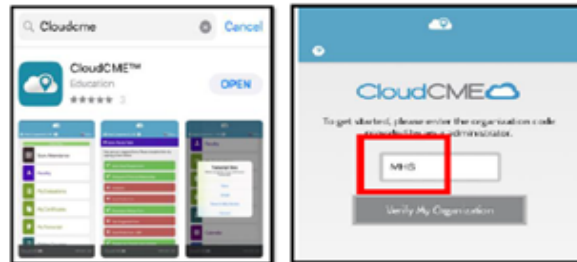

4. Memorial Healthcare System staff must log-in using MHS' email address and Password (same password used for Epic and desktop log-in). Non- Memorial Healthcare System staff must log-in with the email address and password used to create the CloudCME account/profile.
5. After logging in, verify all information in your profile is complete and accurate.
*** VERY IMPORTANT:** verify your license number/information is entered for credits reporting.



6. Go back to mobile app's main menu, scroll down and click on the tab "Claim Credit".
7. Type the activity's *Event ID*, and click the grey button "Verify Event ID". Follow the instructions to attest attendance and click submit.

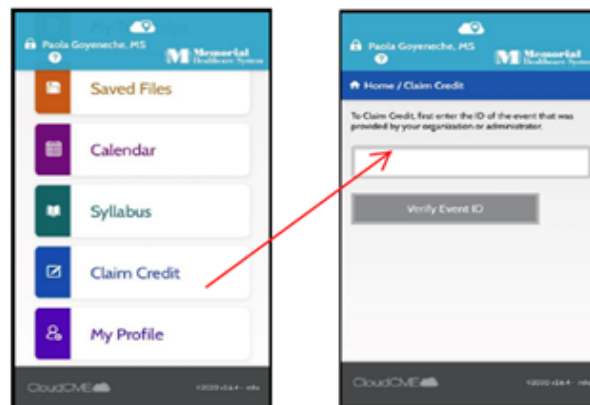



Download the mobile app (instructions on page 6) to claim credits, complete required evaluation and download the certificate.

FRIDAY, AUGUST 1ST

➤ **Activity ID # 22475**

Day 1 Best of ASCO® 2025 Miami Symposium



<https://mhs.cloud-cme.com/WebService/SelfAttendScan.aspx?EventID=22475>

SATURDAY, AUGUST 2ND

➤ **Activity ID # 22476**

Day 2 Best of ASCO® 2025 Miami Symposium



<https://mhs.cloud-cme.com/WebService/SelfAttendScan.aspx?EventID=22476>

QR code must be scanned via CloudCME app

MEDICAL DIRECTOR

Luis E. Raez, MD, FACP, FCCP

Chief Scientific Officer & Medical Director
Memorial Cancer Institute/Memorial Health Care System
Co-Director MCI/FAU Florida Cancer Center of Excellence
Clinical Research Professor Florida Atlantic University
Clinical Professor of Medicine Florida International University
Memorial Healthcare System
Memorial Cancer Institute

EDUCATIONAL COMMITTEE

Dina Dumercy McHenry, PharmD, MBA, BCOP
Gregg B. Fields, PhD, FNAI
Hugo F. Fernandez, MD
Jorge Garcia, Pharm. D, MS, MHA, MBA, FACHE
Katerine Dumais, PharmD, MPH, BCOP
Mary Mackrell, RN, MSN, MED, OCN, BMTCN
Matthew P. Salzberg, MD
Saima Chaudhry, MD, MSHS

PLANNING COMMITTEE

Meredith B. Feinberg, MBA, FACHE, CPXP
Atif Hussein, MD, MMM, FACP
Syeda Hussain, MD, MPH

CME Department:

Jennifer Lopes
Emily Vaught
Zalika Topping-Rousseau
Laudz Fenelus

Non-faculty contributors and others involved in the planning, development and editing/review of the content have no relevant financial relationships with ineligible companies to disclose.

Agarwala, Sanjiv S. MD, FASCO

Professor
Temple University
Center Valley, PA

Ahluwalia, Manmeet S. MD, MBA, FASCO

Chief of Medical Oncology
Chief Scientific Officer & Deputy Director
Miami Cancer Institute
Baptist Health South Florida
Miami, FL

Borad, Mitesh J. MD

Getz Family Professor of Research
Professor of Medicine, Mayo Clinic College of
Medicine and Science
Program Leader, Novel Therapeutics and
Therapeutic Modalities Program
Mayo Clinic Comprehensive Cancer Center
Phoenix, AZ

Cappuzzo, Federico MD

Director and Chief
Division of Medical Oncology 2
IRCCS Regina Elena National Cancer Institute
Rome, Italy

Cusnir, Mike MD

Assistant Professor of Medicine
Columbia University School of Medicine
The Pulver Family Division Chief of Hematology and
Oncology
Co-Director, GI Cancer Program
Mount Sinai Medical Center
Miami Beach, FL

Fields, Gregg B. PhD, FNAI

Vice President for Research
Florida Atlantic University
Boca Raton, FL

Garrido-Castro, Ana C. MD

Assistant Professor of Medicine, Harvard Medical
School
Director, Triple-Negative Breast Cancer Research
Susan F. Smith Center for Women's Cancers
Department of Medical Oncology, Dana-Farber
Cancer Institute
Boston, MA

Gil-Aldea, Isabel MD, PhD

Medical Consultant
Central Unit for Clinical Trials
Clínica Universidad de Navarra
Pamplona, Spain

Gil-Bazo, Ignacio MD, PhD

Head, Department of Oncology
Vithas Institute of Oncology
Vitoria, Spain

Jantus Lewintre, Eloisa PhD

Associate Professor of Cell Biology
Polytechnic University of Valencia
Valencia, Spain

Kim, Richard MD

Service Chief of GI Medical Oncology
Institution
Moffitt Cancer Center
Tampa, FL

Lally, Brian MD, FACRO

Associate Professor and Vice-Chair for Operations
Department of Radiation Oncology, & Hollings
Cancer Center
Medical University of South Carolina
Charleston, SC

GUEST FACULTY

Lim, Bora MD

Associate Professor
The University of Texas MD Anderson Cancer
Center
Houston, TX

Olawaiye, Alexander MD

Professor
University of Pittsburgh
Pittsburgh, PA

Park, Chandler H. MD, MSC, FACP

Co-Director Genitourinary Clinical Trials
Norton Cancer Institute
Advisory Dean/Clinical Professor of Medicine
University of Louisville School of Medicine
Louisville, KY

Patel, Kashyap MD

CEO
Carolina Blood and Cancer
Rock Hill, SC

Pellini, Bruna MD

Medical Oncologist, Assistant Member,
Department of Thoracic Oncology
Moffitt Cancer Center
Tampa, FL

Rabinowits, Guilherme MD

Senior Member, Department of Head and Neck-
Endocrine Oncology
Moffitt Cancer Center
Tampa, FL

Rodriguez, Estelamari MD, MPH

Clinical Research Lead, Thoracic Site Disease Group
Associate Director Community Outreach
Sylvester Comprehensive Cancer Center
University of Miami
Miami, FL

Rodríguez Abreu, Delvys MD, PhD

Head of Medical Oncology Department
Associate Professor of Medicine ULPGC
Hospital Universitario Insular de Gran Canaria
Las Palmas de Gran Canaria, Spain

Schatz, Alyssa DrPH, MSW

Vice President, Policy & Advocacy
National Comprehensive Cancer Network (NCCN®)
Plymouth Meeting, PA

Shields, Misty Dawn, MD, PhD

Assistant Professor of Clinical Medicine, IUSOM
Adjunct Assistant Professor of Medical & Molecular
Genetics
Associate Member, Experimental and
Developmental Therapeutics
Department of Medicine, Division of
Hematology/Oncology, Thoracic Oncology
Indiana University Melvin & Bren Simon
Comprehensive Cancer Center
Indianapolis, IN

Singhi, Eric K. MD

Assistant Professor,
University of Texas MD Anderson Cancer Center,
Houston, TX

Sonpavde, Guru P. MD

Director of Phase I Clinical Research &
Genitourinary Medical Oncology
Christopher K. Glanz Chair for Bladder Cancer
Research
AdventHealth Cancer Institute
Professor of Medicine, University of Central Florida
Orlando, FL

MEMORIAL HEALTHCARE SYSTEM FACULTY

Álvarez, Andrés MD, PhD, E-MHA

Research Professor, Florida Atlantic University
Consultant Director of Research Operations
Memorial Cancer Institute
Office of Human Research
Memorial Healthcare System
Pembroke Pines, FL

Carracedo Uribe, Carlos MD

Hematology/Oncology Fellow
Memorial Healthcare System
Pembroke Pines, FL

Castrellon, Aurelio B. MD

Medical Oncologist
Memorial Cancer Institute
Pembroke Pines, FL

Castellon, Ignacio MD

Chief, Radiation Oncology
Memorial Cancer Institute
Pembroke Pines, FL

Dalal, Shivani, MD

Hematology/Oncology Fellow
Memorial Healthcare System
Pembroke Pines, FL

Domingo, Gelenis MD

Hematology/Oncology Physician
Memorial Cancer Institute
Pembroke Pines, FL

Ergle, Alejandra F., MD

Breast Medical Oncologist
Memorial Healthcare System
Pembroke Pines, FL

Fabregas Mercado, Jesus MD, MPH, FACP

Clinical Research Assistant Professor, FAU
Gastrointestinal Oncologist
Memorial Cancer Institute
Memorial Healthcare System
Hollywood, FL

Feinberg, Meredith B. MBA, FACHE, CPXP

Vice President of Oncology Services
Memorial Cancer Institute
Memorial Healthcare System
Hollywood, FL

Fernandez, Hugo MD

Chair, Moffitt Medical Group
Department of Malignant Hematology and Cellular
Therapies
Moffitt Cancer Center at Memorial Health System
Hollywood, FL

Ferraro, Pablo MD

Hematologist-Oncologist
Memorial Cancer Institute
Pembroke Pines, FL

Gannon, Christopher MD

Chief, Surgical Oncology
Memorial Cancer Institute
Pembroke Pines, FL

Guaqueta Segura, Delia C. MD

Breast Medical Oncologist
Memorial Cancer Institute
Hollywood, FL

Hunis, Brian MD

Medical Director, Medical Oncology
Memorial Healthcare System
Pembroke Pines, FL

Hussein, Atif MD, MMM, FACP

Program Director
Hematology Oncology Fellowship Program
Memorial Healthcare System
Medical Director
General Hematology Oncology
Clinical Affiliate Professor: Florida Atlantic
University Charles E. Schmidt College of Medicine,
Florida International University Wertheim School of
Medicine, University of Miami Miller School of
Medicine
Hollywood, FL

King, Kelly MBA, LSSBB

Senior Director, Oncology Operations
Memorial Cancer Institute
Hollywood, FL

Muminovic, Meri MD

Hematologist-Oncologist
Memorial Healthcare System
Pembroke Pines, FL

Nguyen, Nina Thuha, MD

Assistant Member, Department of Malignant
Hematology and Cellular Therapy at Memorial
Healthcare System
Moffitt Malignant Hematology & Cellular Therapy
Memorial Healthcare System
Pembroke Pines, FL

Pico, Brian MD

Genitourinary Medical Oncologist, Division of
Hematology/Oncology
Memorial Cancer Institute
Memorial Healthcare System
Clinical Research Assistant Professor
Florida Atlantic University (FAU)
Pembroke Pines, FL

Plagov, Andrei MD

Anatomic and Clinical Pathology
Memorial Cancer Institute
Pembroke Pines, FL

Raez, Luis E. MD, FACP, FCCP

Chief Scientific Officer & Medical Director
Co-Director MCI/FAU Florida Cancer Center of
Excellence
Clinical Research Professor FAU
Clinical Professor of Medicine FIU
Memorial Healthcare System
Memorial Cancer Institute
Pembroke Pines, FL

Rosas, Daniel MD

Hematology/Oncology Fellow
Memorial Healthcare System
Pembroke Pines, FL

Rueth, Natasha M. MD, MS, FACS

Director Breast Oncology Services
Memorial Healthcare System
Hollywood, FL

Sandoval-Sus, Jose MD, FACP

Associate Member
Department of Malignant Hematology and Cellular
Therapy
Moffitt Cancer Center at Memorial Healthcare
System
Clinical Affiliate Associate Professor of Hematology-
Oncology, Department of Medicine, Florida Atlantic
University
Pembroke Pines, FL

Silva Rondon, Carlos Humberto, MD

Assistant Member
Moffitt Malignant Hematology and Cellular
Therapy
Memorial Cancer Institute
Pembroke Pines, FL

Sood, Amit, MD

Radiation Oncology
Memorial Cancer Institute
Pembroke Pines, FL

Vargas Madueno, Fernando Manuel MD

Assistant Member, Department of Malignant
Hematology and Cellular Therapy at Memorial
Healthcare System
Moffitt Cancer Center
Pembroke Pines, FL

Arsenault, Michelle, BS in Biology Cell Therapy

Associate Scientist, R&D
Gift of Life Center for Cell and Gene Therapy
Boca Raton, FL

Bacallao, Giselle BSN, RN, OCN, BMTCN

BMT Quality Manager
Memorial Cancer Institute
Pembroke Pines, FL

Dorta, Glorymar BSN, RN, Lean Yellow Belt

Breast Cancer Patient and Family Navigator
Breast Cancer Center
Memorial Healthcare System
Pembroke Pines, FL

Dumais, Katerine PharmD, MPH, BCOP

Pharmacy Clinical Coordinator, Oncology Residency
Program Director, PGY2 Oncology Pharmacy
Memorial Cancer Institute
Pembroke Pines, FL

Elder, Christopher PharmD, BCOP

Associate Director of Pharmacy Clinical Services
Pharmacy Operations
Florida Cancer Specialists & Research Institute
Tampa, FL

Fernandez, Heidy PharmD

Medication Safety and Quality Coordinator
Memorial Cancer Institute
Pembroke Pines, FL

Hakimata, Paul MBA, Ing., LSSBB, MB(ASCP)

Specialist Molecular Genomics
Principle Investigator, MCI - FAU
Memorial Healthcare System
Hollywood, FL

Hernandez, Luis BA, MSF, PharmD, BCOP

Pharmacy Supervisor
Memorial Cancer Institute
Pembroke Pines, FL

Jacques, Jessica DNP, APRN, FNP-BC

Senior Director of Population Health
Memorial Healthcare System
Miramar, FL

Mackrell, Mary MSN, RN, MED, OCN, BMTCN

Director of Education & Professional Development
Memorial Cancer Institute
Pembroke Pines, FL

Mancia, Stefania MSN, APRN

Survivorship APP
Moffitt Malignant Hematology and Cellular Therapy
at Memorial Cancer Institute
Pembroke Pines, FL

Powery II, Hermán Wesley PharmD, BCOP

Oncology Pharmacy Clinical Coordinator of Solid
Tumors, Investigational Drug Services & Integrative
Oncology
Memorial Cancer Institute
Hollywood and Pembroke Pines, FL

Quintana, Barbie MSN, RN, ONN-CG

Patient Care Manager
Patient Navigation
Miami Cancer Institute
Miami, FL

Qureshi, Khurrum PharmD, BCOP

Head and Neck, Thoracic Clinical Pharmacy
Specialist
Baptist Health South Florida/Miami Cancer
Institute
Miami, FL

**Ramos Morales, Alga S. PharmD, MS, MBA, BCPS,
BCOP, CSSGB**

Medical Oncology Pharmacy Clinical Coordinator
PGY-2 Oncology Pharmacy Residency Research
Coordinator
Miami Cancer Institute
Baptist Health Cancer Care
Miami, FL

PHARMACY AND NURSING FACULTY

Rodriguez, Michelle PharmD, BCPS, BCOP

Oncology Pharmacy Supervisor
Memorial Cancer Institute
Pembroke Pines, FL

Walko, Christine M., PharmD, BCOP, FCCP, FASCO

Senior Member, Department of Pathology
Attending, Precision Medicine Clinical Service
Moffitt Cancer Center
Tampa, FL

Salina, Maray MSN, APRN, FNP-BC

Director, Oncology Support Services
Memorial Healthcare System
Pembroke Pines, FL

DISCLOSURES

In accordance with the Standards for Integrity and Independence issued by the Accreditation Council for Continuing Medical Education (ACCME), Memorial Healthcare System mitigates all conflicts of interest to ensure CME activities are free of commercial bias.

The following have no relevant financial relationships to disclose:

Sanjiv Agarwala, MD; Andres Alvarez, MD PHD; Michelle Arsenault, BS; Giselle Bacallao, BSN; Mitesh Borad, MD; Federico Cappuzzo, MD; Carlos Carracedo Uribe, MD; Aurelio Castrellon, MD; Ignacio Castellon, MD; Saima Chaudhry, MD; Mike Cusnir, MD; Shivani Dalal, MD; Gelenis Domingo, MD; Glorymar Dorta, BSN; Katherine Dumais, PharmD; Alejandra Ergle, MD; Meredith Feinberg, MBA; Laudz Fenelus; Heidy Fernandez, PharmD; Hugo Fernandez, MD; Pablo Ferraro, MD; Gregg Fields, PhD; Christopher Gannon, MD; Jorge Garcia, PharmD; Isabel Gil-Aldea, MD PHD; Paul Hakimata, MBA; Luis Hernandez, PharmD; Brian Hunis, MD; Syeda Hussain, MD MPH; Atif Hussein, MD; Jessica Jacques, APRN; Brian Lally, MD; Jennifer Lopes; Kelly King, MBA; Mary Mackrell, MSN; Stefania Mancina, AGPCNP-BC; Dina Dumercy McHenry, PharmD; Meri Muminovic, MD; Kashyap Patel, MD; Andrei Plagov, MD; Herman Powery, PharmD; Barbara Quintana, MSN; Khurram Qureshi, PharmD; Alga Ramos Morales, PharmD; Michelle Rodriguez, PharmD; Daniel Rosas, MD; Matthew Salzberg, MD; Carlos Silva Rondon, MD; Maray Salina, APRN; Amit Sood, MD; Zalika Topping-Rousseau ; Fernando Vargas Madueno, MD; Emily Vaught; Christine Walko, PharmD

DISCLOSURES

The following have disclosed relevant financial relationships; all relevant financial relationships have been mitigated:

Manmeet Ahluwalia, MD MBA

Consulting Fee:

Bayer (Any division), Janssen (Any division), Xoft, Nuvation Bio, SDP Oncology, Apollomics, Prelude, Viewray, Caris Lifesciences, Pyramid Biosciences, Varian Medical Systems, Anheart Therapeutics, Theraguix, Menarini Ricerche, Modifi Biosciences, BugWorks, Sumitomo Pharma Oncology, Autem Therapeutics, GT Medical Technologies, Allovir, Equillium Bio, Servier Pharmaceuticals, VBI Vaccine, Incyte Corporation, Recordati

Grant or research support:

Pfizer

Stock options, excluding diversified mutual funds:

MimiVax, LiveAI, Trisalus Lifesciences

Christopher Elder, PharmD

Advisor:

Sanofi S.A. (Relationship has ended), Janssen (Any division) (Relationship has ended), Bristol-Myers Squibb Company (Relationship has ended)

Jesus Fabregas Mercado, MD MPH

Grant or research support:

Novartis Corporation Pharmaceuticals (Relationship has ended), Bristol-Myers Squibb Company (Relationship has ended), Natera (Relationship has ended), Ipsen Biopharmaceuticals, Inc. (Relationship has ended)

Advisor:

Ipsen Biopharmaceuticals, Inc. (Relationship has ended), AstraZeneca (Any division) (Relationship has ended), Bristol-Myers Squibb Company (Relationship has ended)

Ana Garrido-Castro, MD

Grant or research support:

Gilead Sciences, Inc., AstraZeneca (Any division), Daiichi Sankyo, Inc., Merck (Any division), Zenith Epigenetics, Bristol-Myers Squibb Company, Novartis Corporation Pharmaceuticals (Relationship has ended), Biovica, Foundation Medicine, 4D Path, Precede Biosciences, Bicycle Tx

Consulting Fee:

AstraZeneca (Any division), Daiichi Sankyo, Inc., Novartis Corporation Pharmaceuticals (Relationship has ended), Pfizer (Any division) (Relationship has ended)

Honoraria:

AstraZeneca (Any division), Daiichi Sankyo, Inc., Gilead Sciences, Inc., Roche (Any division) (Relationship has ended)

Other: Travel/accommodations/expenses

AstraZeneca (Any division) (Relationship has ended), Roche (Any division) (Relationship has ended), Gilead Sciences, Inc. (Relationship has ended), Daiichi Sankyo, Inc. (Relationship has ended), Novartis Corporation Pharmaceuticals (Relationship has ended), Pfizer (Any division) (Relationship has ended), Merck (Any division) (Relationship has ended)

Ignacio Gil-Bazo, MD PHD

Advisor:

Johnson & Johnson, Boehringer Ingelheim Pharmaceuticals, Inc. (Relationship has ended)

Honoraria:

Merck (Any division) (Relationship has ended), Honoraria-Amgen, Inc. (Relationship has ended)

Delia Guaqueta Segura, MD

Consulting Fee:

AstraZeneca (Any division) (Relationship has ended), Lilly (Any division), Pfizer (Any division) (Relationship has ended)

Eloisa Jantus Lewintre, PhD

Honoraria:

Roche (Any division), Amgen, Inc., AstraZeneca (Any division), Takeda Pharmaceuticals (Any division), Thermofisherscientific, Janssen (Any division), GuardantHealth, MenariniStemline,

Grant or research support:

AstraZeneca (Any division), Merck (Any division), Thermofisherscientific

Richard Kim, MD

Consulting Fee:

Roche (Any division), Incyte Corporation, Ipsen Biopharmaceuticals, Inc., Pfizer (Any division), Eisai, Inc., Bayer (Any division), AstraZeneca (Any division), Taiho Pharmaceutical, AbbVie (Any division)

DISCLOSURES

Bora Lim, MD

Honoraria:

Gilead Sciences (Relationship has ended), Eli Lilly (Relationship has ended), Summit Pharmaceuticals (Relationship has ended)

Nina Thuha Nguyen, MD

Membership on Advisory Committees or Review Panels, Board Membership, etc.

Bristol-Myers Squibb Company (Relationship has ended), Janssen (Any division), Pfizer (Any division)

Alexander Olawaiye, MD

Membership on Advisory Committees or Review Panels, Board Membership, etc.

AstraZeneca (Any division), Merck (Any division), Daiichi Sankyo, Inc., GSK, Eli Lilly

Chandler Park, MD

Speakers Bureau:

Merck (Any division), Eisai, Inc., Seattle Genetics, Inc., Gilead Sciences, Inc., AstraZeneca (Any division)

Advisor:

Exelixis, Inc., Bristol-Myers Squibb Company, Seattle Genetics, Inc., Gilead Sciences, Inc., Eisai, Inc., Exelixis, Inc., Pfizer (Any division)

Grant or research support:

Merck (Any division), Bristol-Myers Squibb Company, Bayer (Any division), AstraZeneca (Any division), Gilead Sciences, Inc., Novartis Corporation Pharmaceuticals, Seattle Genetics, Inc., Eisai, Inc., Janssen (Any division)

Bruna Pellini, MD

Grant or research support:

Bristol-Myers Squibb Company, Merck (institution), George Edgecomb Society at Moffitt Cancer Center, NIH/NCI 4UM1-CA186644-07 (institution), NIH/NCI 1R21CA259215-01A1 (institution), Salah Foundation (institution), FL DOH (institution)

Advisor:

Regeneron Pharmaceuticals, Inc. (Relationship has ended), AstraZeneca (Any division), Gilead Sciences, Inc., Guardant Health (Relationship has ended), Merus (Relationship has ended), Catalyst (Relationship has ended), Oncohost (Relationship has ended)

Consulting Fee:

Foundation Medicine

Travel support:

AstraZeneca, BMS, Gilead, Regeneron, Merck/MSD

Brian Pico, MD

Advisor:

Janssen (Any division) (Relationship has ended)

Guilherme Rabinowits, MD

Advisor:

Merus, Coherus, Exelixis, Inc. (Relationship has ended), Merck (Any division) (Relationship has ended)

Luis Raez, MD

Grant or research support:

Bristol-Myers Squibb Company, Lilly (Any division), Merck (Any division), Genentech (Any division), Bayer (Any division), AbbVie (Any division), Seattle Genetics, Inc.

Consulting Fee:

Lilly (Any division) (Relationship has ended), Bayer (Any division) (Relationship has ended), Corporation Pharmaceuticals (Relationship has ended), AstraZeneca (Any division) (Relationship has ended), Merck (Any division) (Relationship has ended)

Estelamari Rodriguez, MD

Consulting Fee:

Amgen, Inc., Daiichi Sankyo, Inc. (Relationship has ended), Boehringer Ingelheim Pharmaceuticals, Inc., AstraZeneca (Any division), Novocure (Relationship has ended), Regeneron Pharmaceuticals, Inc. (Relationship has ended)

Advisor:

Pfizer (Any division) (Relationship has ended), Janssen (Any division)

Delvys Rodríguez Abreu, MD PHD

Consulting Fee:

Pfizer (Any division) Consulting Fee-AstraZeneca (Any division), Bristol-Myers Squibb Company, Lilly (Any division)

Membership on Advisory Committees or Review Panels, Board Membership, etc.

Roche (Any division), Gilead Sciences, Inc., Merck (Any division)

Natasha Rueth, MD

Consulting Fee:

Astrin Bioscience (Relationship has ended)

DISCLOSURES

Jose Sandoval-Sus, MD

Speakers Bureau:

Pfizer (Any division)

Consulting Fee:

Janssen (Any division) (Relationship has ended), Beigene (Relationship has ended), ADC therapeutics (Relationship has ended), Bristol-Myers Squibb Company (Relationship has ended), Genmab (Relationship has ended), AbbVie (Any division) (Relationship has ended), Roche (Any division) (Relationship has ended), Acrotech (Relationship has ended), Kite Pharma (Relationship has ended), Genentech (Any division) (Relationship has ended), Novartis Corporation Pharmaceuticals (Relationship has ended)

Alyssa Schatz, DrPH, MSW

Grant or research support:

AbbVie (Any division), 2seventybio, Genentech (Any division), Lilly (Any division), Sanofi S.A., Genzyme (Any division), Bristol-Myers Squibb Company, GSK, Pfizer (Any division), Merck (Any division)

Misty Shields, MD PHD

Speakers Bureau:

Jazz Pharmaceuticals, Inc. (Relationship has ended)
Paid Consultant:
Jazz Pharmaceuticals, Inc. (Relationship has ended), AstraZeneca (Any division)

Eric Singhi, MD

Advisor:

AstraZeneca (Any division) (Relationship has ended), Novocure (Relationship has ended), Amgen, Inc. (Relationship has ended), Janssen (Any division) (Relationship has ended), Regeneron Pharmaceuticals, Inc. (Relationship has ended), Bristol-Myers Squibb Company (Relationship has ended), Bayer (Any division) (Relationship has ended), Boehringer Ingelheim Pharmaceuticals, Inc. (Relationship has ended), Lilly (Any division) (Relationship has ended), CARIS (Relationship has ended)

Grant or research support:

Rexannas Foundation for Fighting Lung Cancer (Relationship has ended)

Guru Sonpavde, MD

Consulting Fee:

EMD Serono, Bristol-Myers Squibb Company, Merck (Any division), Seattle Genetics, Inc., Astellas (Any division), Janssen (Any division), Bicycle, Pfizer (Any division), Gilead Sciences, Inc., Scholar Rock, Lilly (Any division), Aktis, Daiichi Sankyo, Inc., Syapse (Relationship has ended)

Grant or research support:

Jazz Pharmaceuticals, Inc. (Relationship has ended), Gilead Sciences, Inc., EMD Serono (Relationship has ended), Bristol-Myers Squibb Company (Relationship has ended), Exelixis, Inc.

Grant or research support:

Bayer (Any division), Blue Earth Diagnostics, Sumitomo Pharma

Speakers Bureau:

Seattle Genetics, Inc., Gilead Sciences, Inc., Natera, Exelixis, Inc., Janssen (Any division), Astellas (Any division), Bayer (Any division), Aveo, Merck (Any division), Pfizer (Any division), AstraZeneca (Any division), Onvivo

Advisor:

GSK

Other: Travel support to conference

Bristol-Myers Squibb Company (Relationship has ended), Astellas (Any division)

Honoraria:

Dava Oncology (Relationship has ended), PracticeUpdate by Elsevier, Uptodate author (Relationship has ended)

*A special **Thank You** to **SOUTH FLORIDA HOSPITAL NEWS**.*

*A special **Thank You** to Memorial Cancer Institute's
Educational Partners:*

FLORIDA SOCIETY OF CLINICAL ONCOLOGY (FLASCO)

**MOFFITT MALIGNANT HEMATOLOGY AND CELLULAR THERAPY
PROGRAM at Memorial Healthcare System**

FLORIDA ATLANTIC UNIVERSITY (FAU)

PROGRAM SCHEDULE		FRIDAY- August 1, 2025
6:30am - 7:50am	Registration, Coffee and Visit Exhibits	
7:50am	Welcome and Introductions - Metropolitan Ballroom MET 1	Luis E. Raez, MD
8:00am – 9:00am	MORNING SESSION Metropolitan Ballroom MET 1	Moderator: Shivani Dalal, MD
8:00am	Gynecology-Oncology: New Targets and Immunotherapy Developments	Alexander Olawaiye, MD
8:20am	Updates in Melanoma and Skin Cancers	Sanjiv S. Agarwala, MD
8:40am	<i>Panel Discussion and Q & A</i>	
8:50am	Breakfast & Transfer to Satellite Symposia	
9:00am – 10:00am	<u>CME Accredited Satellite Symposia Provided by: PER</u> Community Oncology Connections™: Enhancing Melanoma Outcomes with Intratumoral Oncolytic Immunotherapy: Strategies for the Multidisciplinary Team <u>Breakout Room MET 2-3</u>	
10:00am	Break and Visit Exhibits - Metropolitan Ballroom MET 5	
10:10am - 12:00pm	BREAST CANCER Metropolitan Ballroom MET 1	Moderators: Alejandra Ergle, MD Natasha Rueth, MD
10:10am	Updates on HER2 Positive Breast Cancer	Delia C. Guaqueta, MD
10:30am	Hormonal Receptor Positive Breast Cancer Adjuvant and Metastatic Indications	Aurelio Castrellon, MD
10:50am	Antibody Drug Conjugates (ADCs) Coming to Primetime and New Agents	Bora Lim, MD
11:10am	Updates on Triple Negative Breast Cancer and Immunotherapy	Ana Garrido-Castro, MD
11:30am	<i>Panel Discussion and Q & A</i>	
11:40am	MULTIMODALITY BREAST CANCER NON-CME Metropolitan Ballroom MET 1 <i>*This session is not certified for CME credit and is not part of the accredited CME program. It is intended solely for educational and discussion purposes and has not received commercial support. *</i>	Natasha Rueth, MD
12:00pm	Transfer to Lunch	
12:20pm – 1:20pm	<u>NON-CME Lunch</u> <u>Product Theater brought to you by: OncLive</u> <u>Breakout Room MET 2-4</u>	
1:20pm - 1:50pm	Dessert Break and Visit Exhibitors - Metropolitan Ballroom MET 5	
1:50pm – 3:10pm	GASTROINTESTINAL TUMORS Metropolitan Ballroom MET 1	Moderators: Pablo Ferraro, MD Jesus Fabregas, MD
1:50pm	Esophageal, Gastric and GE Junction Tumors	Mike Cusnir, MD
2:10pm	Pancreatic, Hepatic and Biliary Malignancies	Mitesh Borad, MD
2:30pm	Colorectal Malignancies: Good News from New Agents and ctDNA Monitoring	Richard Kim, MD
2:50pm	<i>Panel Discussion and Q & A</i>	

PROGRAM SCHEDULE

FRIDAY- August 1, 2025

3:10pm - 4:00pm	INTERNATIONAL SOCIETY OF LIQUID BIOPSIES & MEMORIAL CANCER INSTITUTE SYMPOSIA: MOVING FORWARD WITH LIQUID BIOPSIES AND MOLECULAR TESTING <i>Metropolitan Ballroom MET 1</i>	Moderators: Estelamari Rodriguez, MD Daniel Rosas, MD
3:10pm	Liquid Biopsies from ctDNA to cfRNA, Exosomes, Fragmentomics and CTC's	Eloisa Jantus, MD
3:30pm	Clinical Utility of Liquid Biopsies in Solid Tumors from Diagnosis to Tumor Tracking and Resistance	Bruna Pellini, MD
3:50pm	<i>Panel Discussion and Q & A</i>	
4:00pm – 4:20pm	Break and Visit Exhibitors - Metropolitan Ballroom MET 5	
4:20pm – 5:40pm	BRAIN TUMORS, HEAD & NECK, AND THYROID CANCERS <i>Metropolitan Ballroom MET 1</i>	Moderators: Amit Sood, MD Brian Hunis, MD
4:20pm	Head & Neck Cancers	Guilherme Rabinowits, MD
4:40pm	GIST Tumors and Soft Tissue Sarcomas	Atif Hussein, MD
5:00pm	Brain Tumors and Brain Metastasis	Manmeet S. Ahluwalia, MD
5:20pm	<i>Panel Discussion and Q & A</i>	
5:40pm	Adjourn	
4:20pm–6:00pm	Breakout Session MULTIDISCIPLINARY CANCER CARE <i>Metropolitan Ballroom MET 2</i>	Moderators: Katerine Dumais, PharmD Mitchelle Rodriguez, PharmD
4:20pm	Implementation of Bispecific Antibodies for Solid Tumor Malignancies	Heidy Fernandez, PharmD Khurram Qureshi, PharmD Christopher Elder, PharmD
4:50pm	Oncology Stewardship	Luis Hernandez, PharmD Alga S. Ramos Morales, PharmD
5:20pm	Cannabis Use in Patients with Cancer	Herman W. Powery II, PharmD
5:50pm	<i>Panel Discussion and Q & A</i>	
6:00pm	Adjourn	
4:20pm – 6:00pm	Breakout Session MOLECULAR ONCOLOGY AND TRANSLATIONAL MEDICINE PRESENTED BY FLORIDA ATLANTIC UNIVERSITY (FAU) <i>Metropolitan Ballroom MET 4</i>	Moderator: Andrei Plagov, MD Gregg B. Fields, PhD
4:20pm	New Technologies to Improve Molecular Testing in Cancer	Paul Hakimata, PhD
4:40pm	Challenges in Establishing and Administering a Tumor Bank (Biorepository)	Isabel Gil-Aldea, MD
5:00pm	Panel Discussion	Andrés Álvarez, MD Christopher Gannon, MD Isabel Gil-Aldea, MD Paul Hakimata, PhD
5:20pm	Amplifying the Gift of Life: Ex Vivo Expansion of HSCs for Transplant	Michelle Arsenault
5:40pm	Molecular Tumor Board: Breast Cancer and GI Cancer Presentations Discussion	Carlos Carracedo Uribe, MD Jesus Fabregas, MD Christine Walko, PharmD
6:00pm	Adjourn	
6:00pm – 7:00pm	Welcome Reception RESIDENTS/FELLOWS POSTER PRESENTATIONS <i>Pre-function South</i>	Moderators: Atif Hussein, MD, Brian Hunis MD Katerine Dumais, PharmD and Syeda Hussain, MD

PROGRAM SCHEDULE		SATURDAY- August 2, 2025
7:30am - 8:20am	Registration, Coffee and Visit Exhibits	
8:20am – 9:10am	GENITOURINARY TUMORS (GU) <i>Metropolitan Ballroom MET 1</i>	Moderator: Brian Pico, MD Matthew Salzberg, MD
8:20am	Prostate Cancer	Chandler Park, MD
8:40am	Bladder and Kidney Cancers	Guru Sonpavde, MD
9:00am	<i>Panel Discussion and Q & A</i>	
9:10am	Breakfast & Transfer to Satellite Symposia	
9:20am – 10:20am	<u>CME Accredited Satellite Symposia Provided by: PER</u> Show Me the Data® New and Emerging Roles for Oral SERD Therapy in the Treatment of ER+/HER2– Breast Cancer <u>Breakout Room MET 2-3</u>	
10:20am	Break and Visit Exhibits - Metropolitan Ballroom MET 5	
10:40am – 11:10am	RADIATION THERAPY UPDATES <i>Metropolitan Ballroom MET 1</i>	Moderator: Ignacio Castellon, MD
10:40am	Updates on Radiation Therapy	Brian Lally, MD
11:00am	<i>Panel Discussion and Q & A</i>	
11:10am – 11:40am	<i>Panel Discussion</i> FLORIDA SOCIETY OF CLINICAL ONCOLOGY & MEMORIAL CANCER INSTITUTE: ADDRESSING SOCIAL DETERMINANTS OF HEALTH IN CANCER CARE <u>NON-CME</u> <i>Metropolitan Ballroom MET 1</i> <small><i>*This session is not certified for CME credit and is not part of the accredited CME program. It is intended solely for educational and discussion purposes and has not received commercial support.*</i></small>	Moderators: Kelly King, MBA Meredith Feinberg, MBA Panel: Kashyap Patel, MD Maray Salina, MSN Alyssa Schatz, DrPH
11:40am	Transfer to Lunch	
11:50am – 12:50pm	<u>NON-CME Lunch</u> <u>Product Theater brought to you by: OncLive</u> <u>Breakout Room MET 2-4</u>	
12:50pm - 1:20pm	Dessert Break and Visit Exhibitors - Metropolitan Ballroom MET 5	
1:20pm - 3:30pm	LUNG CANCER <i>Metropolitan Ballroom MET 1</i>	Moderators: Meri Muminovic, MD Gelenis Domingo, MD
1:20pm	Epidermal Growth Factor Receptor (EGFR), Tyrosine Kinase Inhibitors (TKI) and Anaplastic Lymphoma Kinase (ALK)/ROS-1 Inhibitors	Delvys Rodríguez Abreu, MD
1:40pm	Lung Cancer Immunotherapy Adjuvant and Neoadjuvant Indications	Federico Cappuzzo, MD
2:00pm	Other Therapies for Lung Cancer c-MET, BRAF, KRAS, HER-2	Eric Singhi, MD
2:20pm	Uncommon Genetic Aberrations: NTRK, RET, NRG	Luis E. Raez, MD
2:40pm	Small Cell Lung Cancer Updates	Misty Shields, MD
3:00pm	Biomarkers, Predictive and Prognostic Factors of Resistance to Immunotherapy	Ignacio Gil-Bazo, MD
3:20pm	<i>Panel Discussion and Q & A</i>	
3:40pm	Break and Visit Exhibits - Metropolitan Ballroom MET 5	

PROGRAM SCHEDULE

SATURDAY – August 2, 2025

3:50pm – 5:30pm	Breakout Session HEMATOLOGY MALIGNANCIES & CELLULAR THERAPY PRESENTED BY THE LEE MOFFITT CANCER CENTER AT MEMORIAL HEALTH CARE SYSTEM Metropolitan Ballroom MET 1	Moderator: Hugo Fernandez, MD
3:50pm	Chronic Lymphocytic leukemia (CLL)	Jose Sandoval- Sus, MD
4:10pm	Mantle Cell Lymphoma (MCL)	Carlos Humberto Silva Rondon, MD
4:30pm	Multiple Myeloma	Nina Thuha Nguyen, MD
4:50pm	Acute Lymphocytic Leukemia (ALL)	Fernando Manuel Vargas Madueno, MD
5:10pm	Panel Discussion and Q & A	
5:30pm	Adjourn	
3:50pm – 5:30pm	Breakout Session MULTIDISCIPLINARY CANCER CARE AND SURVIVORSHIP Metropolitan Ballroom MET 2	Moderators: Mary Mackrell, MSN
3:50pm	Cancer Navigation Models Today - Challenges and Opportunities in the Future Q&A	Barbie Quintana, MSN Glorymar Dorta, RN
4:10pm	Reimagining Cancer Survivorship in the 21st Century Q&A	Maray Salina, MSN Giselle Bacallao, BSN Stefania Mancia, APRN
5:00pm	Role of Population Health in Oncology: Innovations, Impact and the Future of Cancer Care Q&A	Jessica Jacques, APRN
5:30pm	Adjourn	

Agenda subject to change

Please remember to claim **credits**, complete the required **evaluation**, and download your **certificate** by **August 22nd**.

Thank you for attending the symposium!
We hope to see you next year for the 2026
Best of ASCO Symposium.

July 31st - August 1st, 2026
JW Marriott Marquis Miami

Questions?

Please contact Memorial Healthcare System's Continuing Medical Education Office at cmedept@mhs.net

